

Click on the “Sign in to Join” button.

Click on the **SSO** button.
Do not sign in with an email.

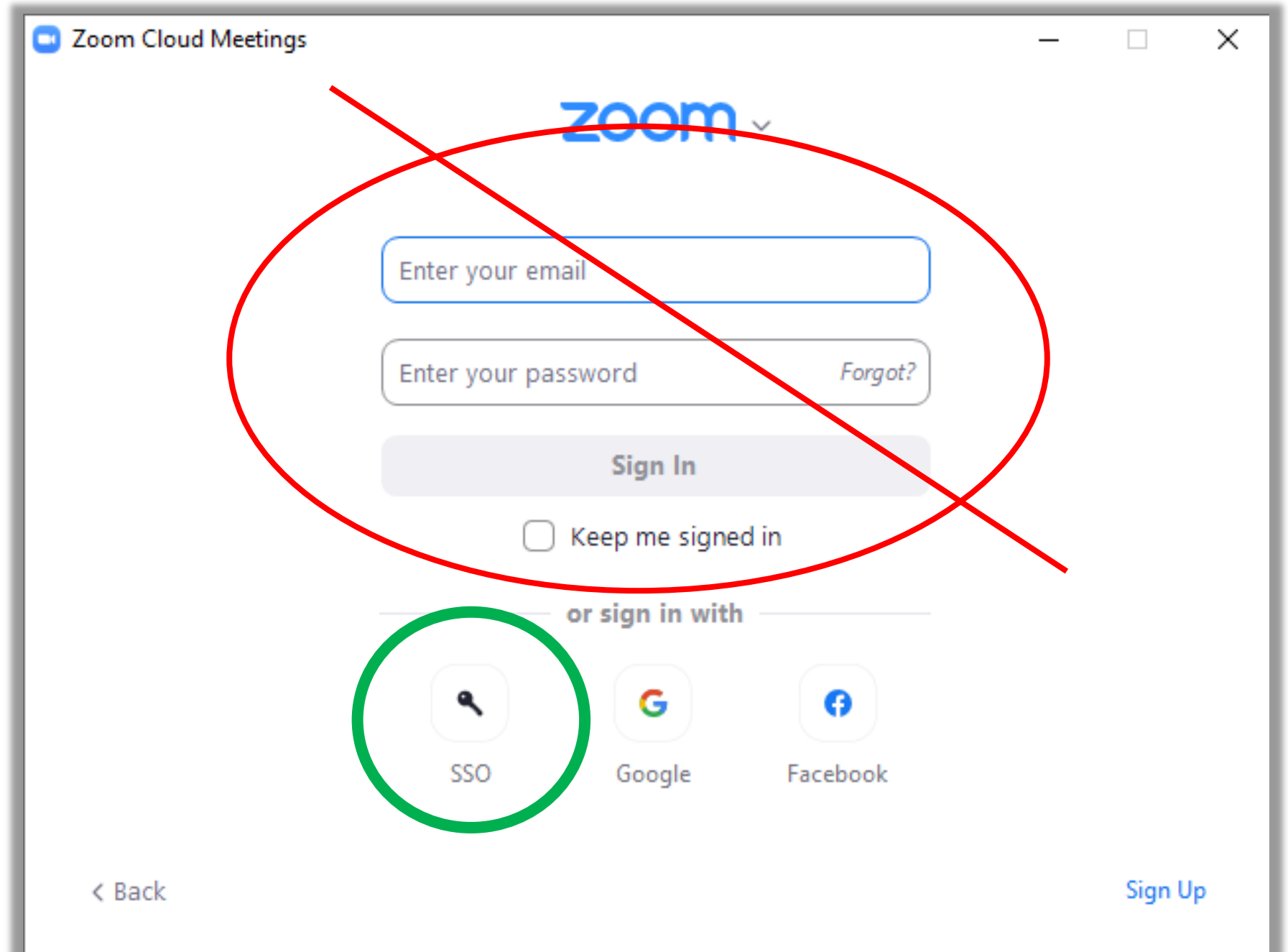

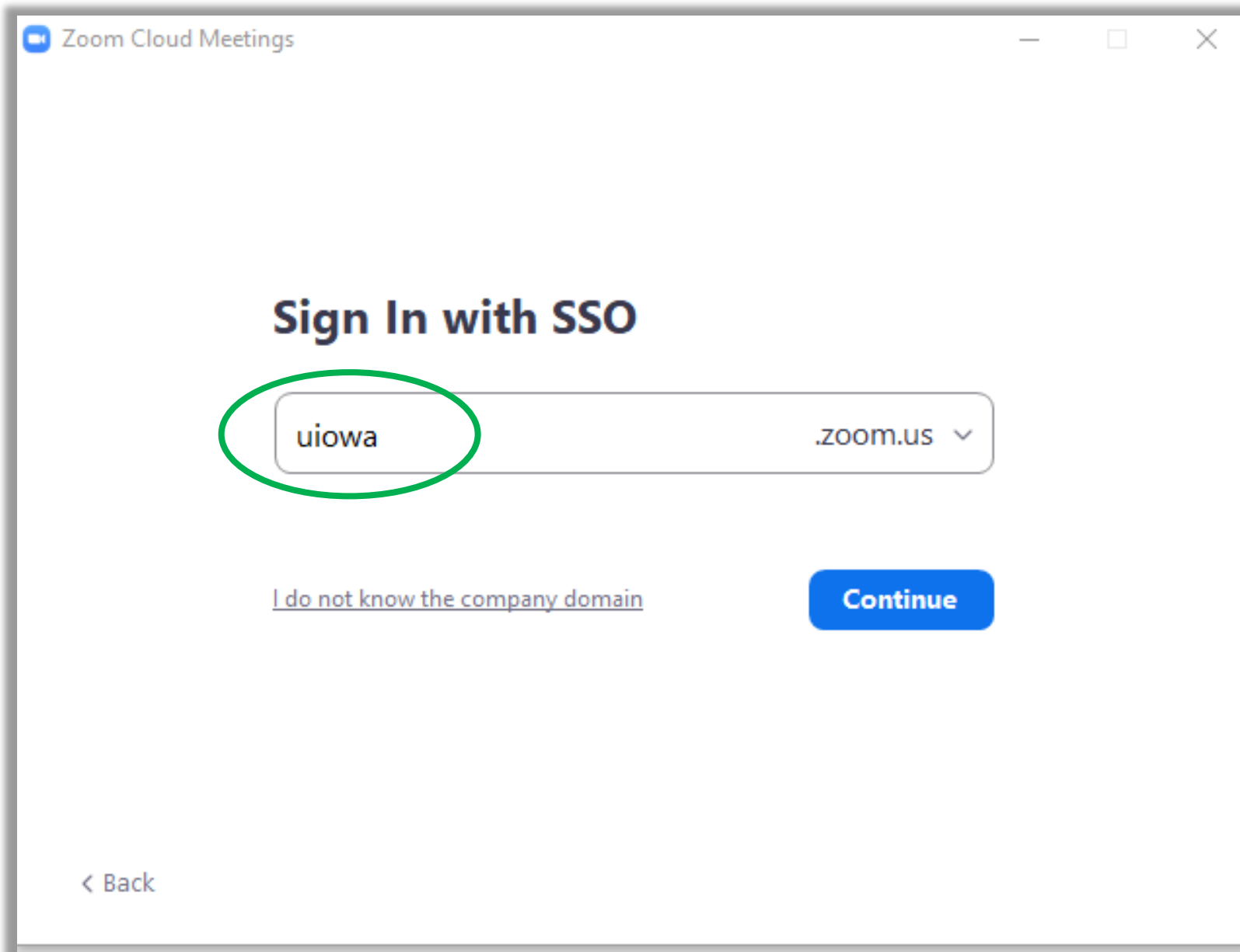

Make sure the uiowa domain is filled in.

University of Iowa Hawk x + v

→ ↻ 🏠 🔒 https://idp.uiowa.edu/idp/profile/SAML2/Redirect/SSO?execution=e1s2 📖 ☆ ⋮

HawkID Login for uiowa.zoom.us



HawkID

Password

[Log In](#) [Forgot your HawkID or password?](#)

You will be logged in to this service securely. Information which will allow you to access the site you requested will be transmitted to the site. This information will be encrypted before it is sent. Please see the ITS Help Desk [Shibboleth support pages](#) for additional information.

Please contact the [ITS Help Desk](#) for assistance, questions, or concerns.

Then sign in with your HawkID and Password.